

Residential Plot for sale in El Rosario, Marbella

500,000 €

Reference: R4604527 Plot Size: 1,166m² Build Size: 323m²

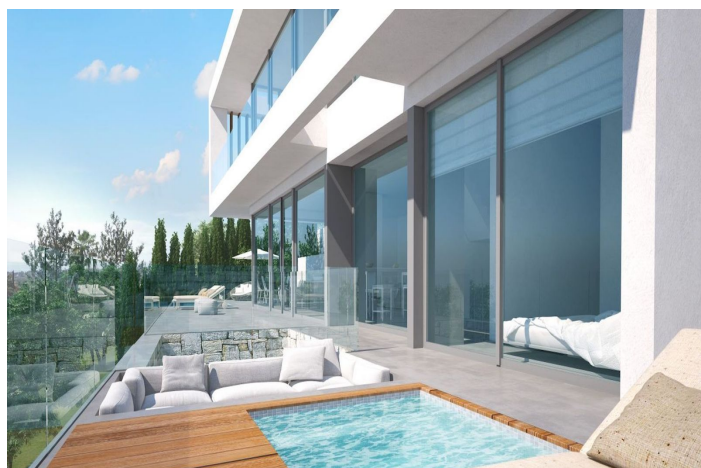

Costa del Sol, El Rosario

A south-west orientated building plot in East Marbella's gorgeous residential estate known as El Rosario.

This plot does not come with a project. The images are only to show the possibility.

This is an opportunity to develop a luxury home with fabulous views over the Marbella countryside and golf course to the Mediterranean Sea.

This plot has a building coefficient of 0.30 allowing therefore for a luxury home with above-ground build size of up to 323 sqm. Additional space can be made in the basement.

El Rosario is undergoing a mandatory update to connect each home to the mains sewage system, and this plot has the infrastructure in place and already paid for at a cost of 12,000 euro.

El Rosario building plot...Marbella East.

A residential plot to build a villa that will have orientation to the west giving spectacular views to the Marbella las Nieves mountain range and also to the sea.

An opportunity to build a fabulous home within 8 minutes of Marbella Town and within 4 minutes of the beach.