

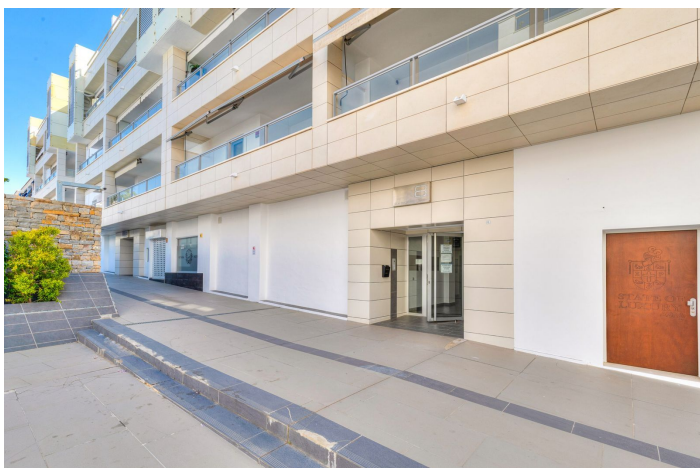

Penthouse for sale in Marbella, Marbella

650,000 €

Reference: R5108869 Bedrooms: 3 Bathrooms: 2 Build Size: 114m² Terrace: 65m²





Costa del Sol, Marbella

Located in the well-established and sought-after residential area of San Pedro Alcántara, Marbella, this stylish duplex penthouse is just 700 metres from the beach, within a well-maintained gated community with a communal swimming pool and easy access to all essential amenities: supermarkets, restaurants, green areas, pharmacies, and public transport. The property is in good general condition, fully habitable and ready to move into, offering a smart layout and generous outdoor spaces that make the most of the Mediterranean lifestyle all year round. Main features: 3 bedrooms with built-in wardrobes 2 full bathrooms (one en suite) Bright living-dining area with direct access to a 20m² main terrace Contemporary design with a kitchen visually connected to the dining area through a practical sliding glass enclosure Independent laundry area Outdoor areas designed for enjoyment: Staircase from the main terrace leading to a large 65.75m² private rooftop solarium Pergola on the upper level, ideal for creating a chill-out zone, outdoor dining area or sunbathing space Communal pool within a quiet and secure development Private underground parking space included in the price Installations and equipment: Central air conditioning with heat pump Electric water heater Well-maintained interior and exterior finishes Low-density community with excellent upkeep An ideal home whether as a primary residence, holiday retreat, or investment property with strong rental potential, in one of the most comfortable and well-connected areas of Marbella. With easy access to the A-7 motorway and just minutes from San Pedro town centre, the beachfront promenade, and the renowned Puerto Banús. The Abbreviated Information Document is at your disposal. Costs: Taxes (ITP or VAT + AJD) + notary and land registry fees. The price does not include VAT.



Features:

Features

Covered Terrace
Near Transport
Ensuite Bathroom
Fitted Wardrobes
Solarium

Views

Street

Pool

Communal

Parking

Underground

Orientation

North East

Setting

Commercial Area
Beachside
Urbanisation
Close To Sea
Close To Marina

Kitchen

Fully Fitted

Utilities

Electricity
Drinkable Water

Climate Control

Air Conditioning
Central Heating

Condition

Good

Garden

Communal
Easy Maintenance

Category

Investment
Contemporary